

# PASTA COOKERS

## BASKET SPECIFICATIONS

### ARCOBALENO® PASTA MACHINES

#### BASKET KEY

ALL PASTA BASKETS SOLD SEPARATELY

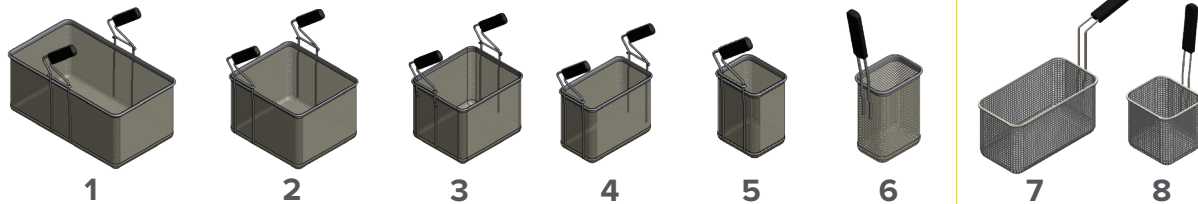

| Basket #        | 1             | 2             | 3             | 4             | 5         | 6         | 7           | 8         |
|-----------------|---------------|---------------|---------------|---------------|-----------|-----------|-------------|-----------|
| Capacity* (lbs) | 14–15 lbs     | 8–9 lbs       | 6–7 lbs       | 3–4 lbs       | 1–2 lbs   | 0.75–1 lb | 2–3 lbs     | 1–1.5 lbs |
| Capacity* (oz)  | 224–240 oz    | 128–144 oz    | 96–112 oz     | 48–64 oz      | 16–32 oz  | 12–16 oz  | 32–48 oz    | 16–24 oz  |
| Capacity* (g)   | 6,350–6,804 g | 3,629–4,082 g | 2,722–3,175 g | 1,361–1,814 g | 454–907 g | 340–454 g | 907–1,361 g | 454–680 g |

\*For short pastas, capacity varies by shape

#### BASKET COMBINATIONS

FOR MODELS: APCT24/25



FOR MODELS: APCT2424/2525



FOR MODELS: APCE28/28D, APCG28/28D

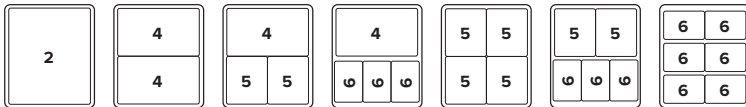

FOR MODELS: AED33/A33, APCE35/35D, APCA35/35D, APCG35/35D, APCG35H/35HA, AGDH35/HA35, AGD35/A35, ADGH35/HA35

